

St Julian's

The images which follow are intended to serve as illustrations to the text which they are published alongside. It is intended that the quality of the images will be improved for publication: the figures should simply be taken as placeholders until that time.

May 2023



Figure 1. St Julians', view from the south.
Wendy Horton/VCH Shropshire, 2022



Figure 2. Medieval respond relocated outside
Wendy Horton/VCH Shropshire, 2022



Figure 3. South view of the medieval church, c. 1820
SA, PR/2/383



Figure 4. North view of the medieval church, Hugh Owen, c. 1825.
SA, 6001/199

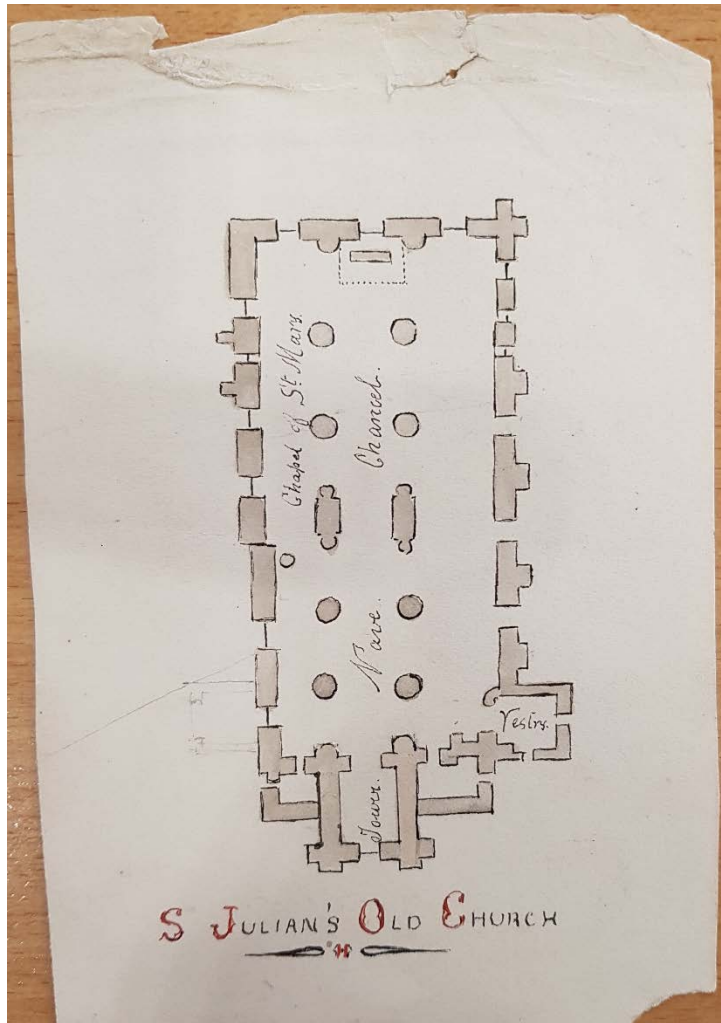

Figure 5. Sketch plan of the medieval church, c. 1750.
SA, xls29674.



Figure 6a. North side of the medieval church c. 1768.
SA, 6001, 299 fo. 00.



Figure 6b. South side of the medieval church, c. 1768
SA, 6001/299



Figure 7. View of the west tower.
Wendy Horton/VCH Shropshire, 2022

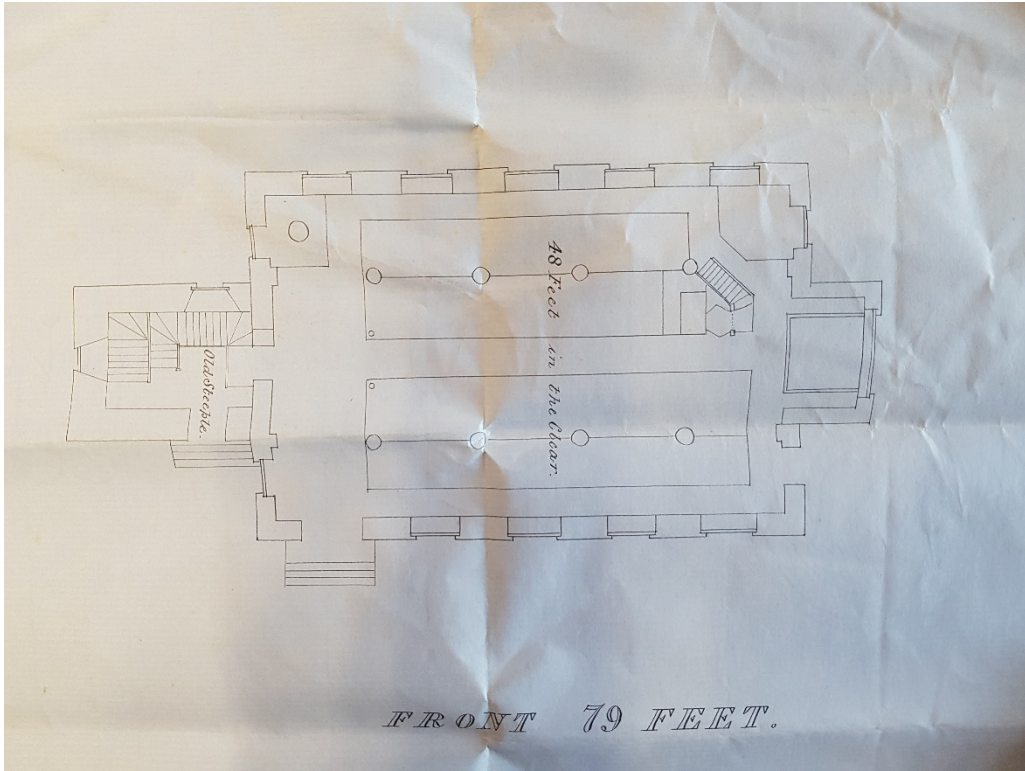

Figure 8. Plan attached to the Faculty for rebuilding the church, 1748 SA, 6000/15004.

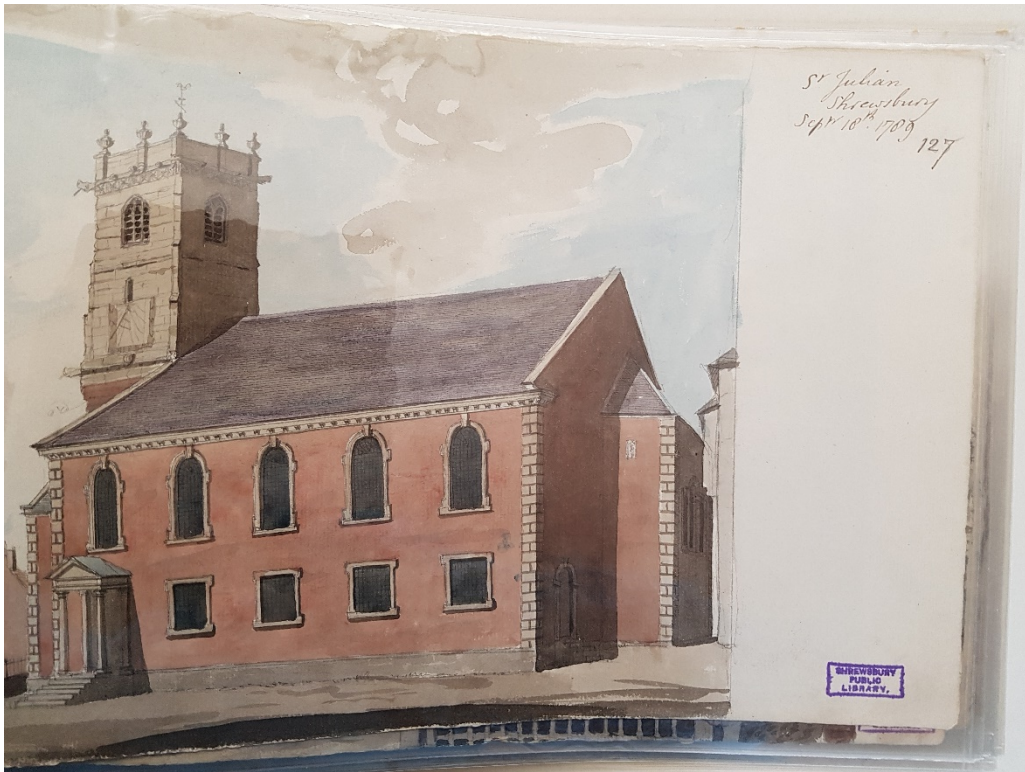

Figure 9. South view, 1789



Figure 10. Photograph of the west gallery including organ, c. 1890
SA, PH/S/13/S/9/27.



Figure 11. East End.
Wendy Horton/VCH
Shropshire, 2022



Figure 12. South front, John Homes Smith, c. 1850

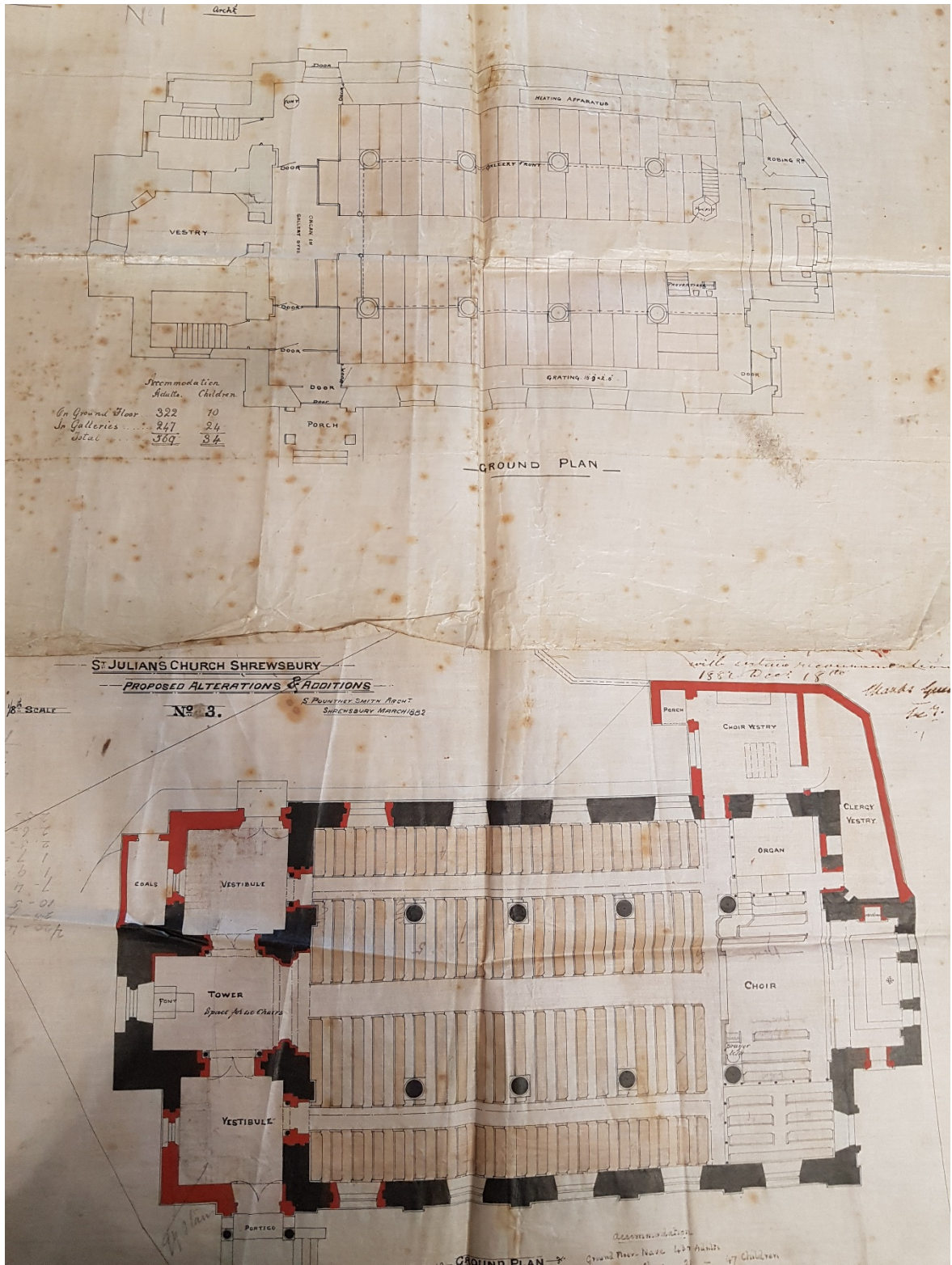

Figure 13. Plans by S. Pountney Smith, 1877 and 1882



Figure 14. Tower Arches
Wendy Horton/VCH Shropshire, 2022



Figure 15. Pulpit
Wendy Horton/VCH Shropshire, 2022

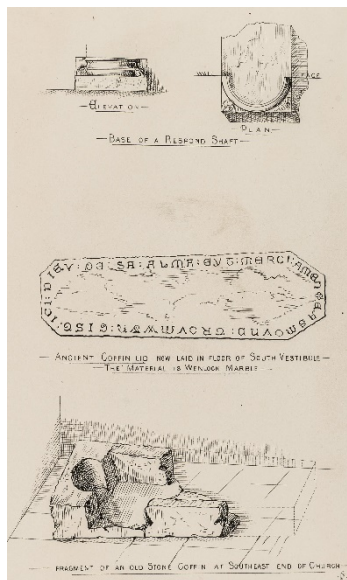

Figure 16. Turwin coffin slab
SA, 6833/4/50



Figure 17. Map of Shrewsbury, John Wood, 1838, showing the relationship of St Julians and St Almonds.
SA, TP/13



Figure 18. Entrance steps and railing, 1822.
SA, SHYMS, FA/1990/26/02